

11/16

Jeremiah Warder & Comp: other land

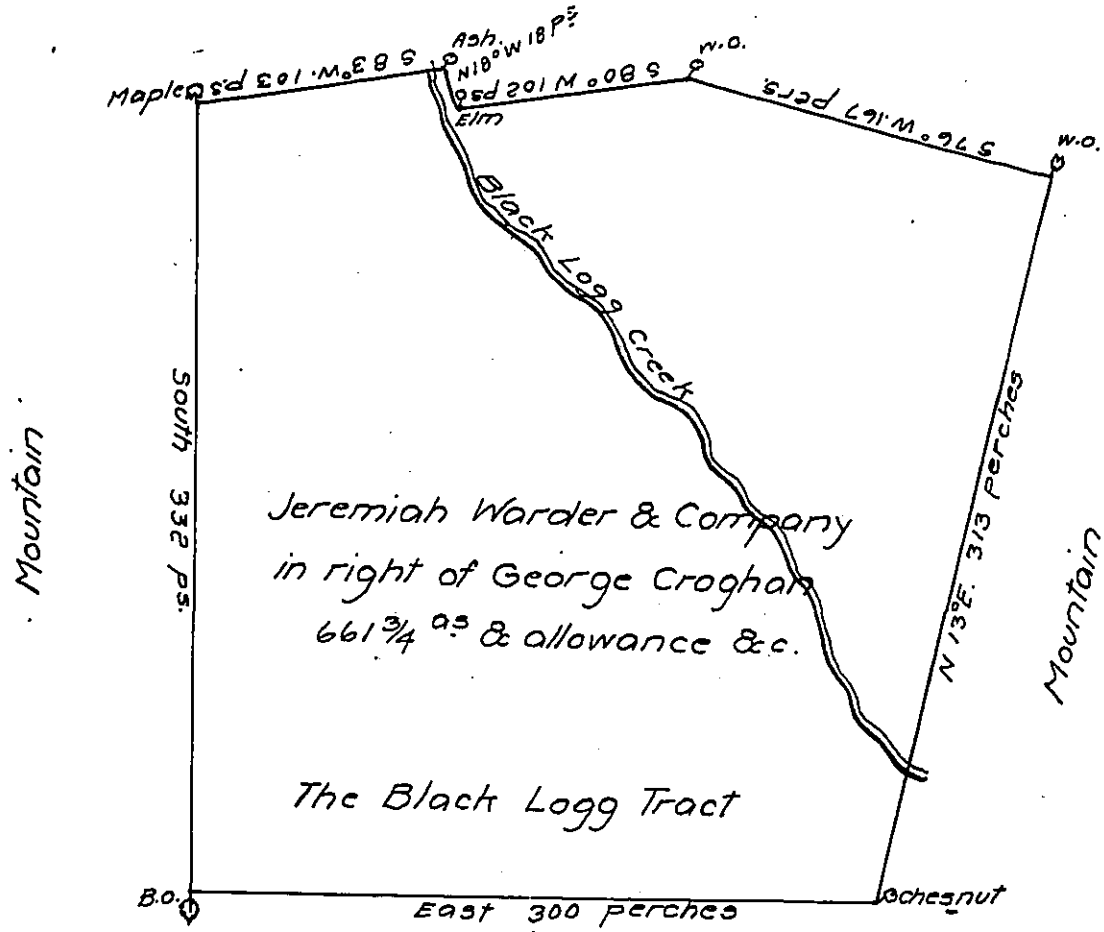

Vacant

A Draught of a tract of Land situate near Aughwick in the County of Cumberland and Containing six hundred and sixty one Acres & three fourth parts of an acre and the usual allowance of Six per cent for roads Surveyed for Jeremiah Warder & Company in right of George Croghan

John Armstrong

D. S.

To John Lukens,
Surveyor General.

IN TESTIMONY that the above is a copy of the original remaining on file in the Department of Internal Affairs of Pennsylvania, made conformably to an Act of Assembly approved the 16th day of February, 1833, I have hereunto set my Hand and caused the Seal of said Department to be affixed at Harrisburg, this Eighteenth day of November 1919

Geo. F. Woodward
Secretary of Internal Affairs.